



Higiene Ocupacional y Medio Ambiente

 SIAFA  
www.siafa.com.ar

# QuantiCheck<sup>®</sup>

 SIAFA  
www.siafa.com.ar

## QUICK START GUIDE



 [www.siafa.com.ar](http://www.siafa.com.ar)

 [ventas@siafa.com.ar](mailto:ventas@siafa.com.ar)

 011 4684 2232

## 1 Charging your QuantiCheck®

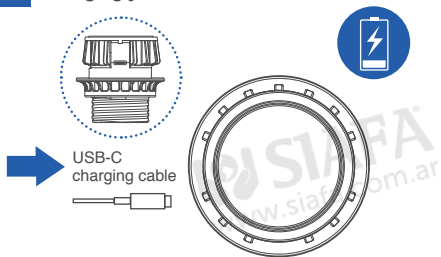

Ensure your QuantiCheck® is fully charged before use. Charging can be done via the USB-C port on the side of the device.

\*Always use USB-C cable supplied

## 2 Attach optional LED extender

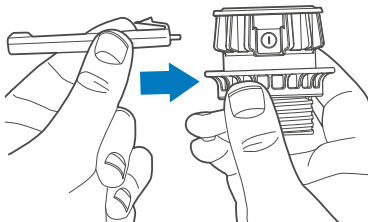

Attach the optional LED extender into the USB-C port if the light on the device is not visible for indication.

## 3 Turn on QuantiCheck®

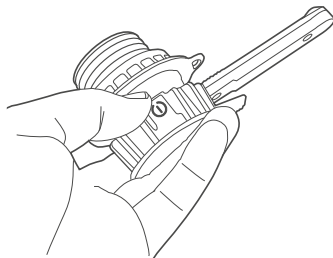

Press and hold power button until green light flashes then release.

## 4 Attach QuantiCheck® device

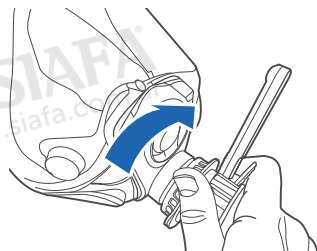

Attach QuantiCheck® on to the mask.

## 5 Don mask



Don your mask and tighten the appropriate straps.

## 6 Perform fit check

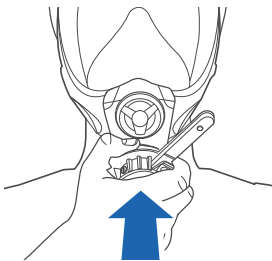

Squeeze or press and hold QuantiCheck® to perform check. Draw a breath until the blinking purple light turns solid, then hold your breath static for up to 10 seconds and wait for result.

## 7 LED indicator - Pass

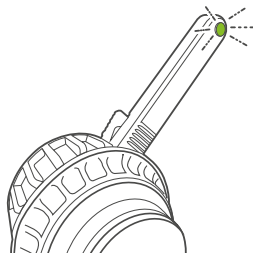

A green light illuminates on the LED indicator for a passed test.

## 7.1 LED indicator - Over breath

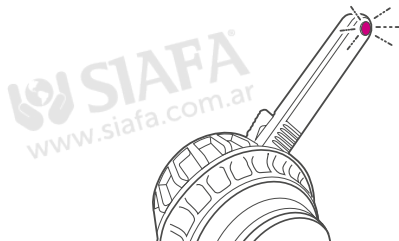

Rapid flashing purple light indicates over breath. Wait a few seconds for purple light to blink slowly. Try again but with a shallower breath.

## 7.2 LED indicator - Fail

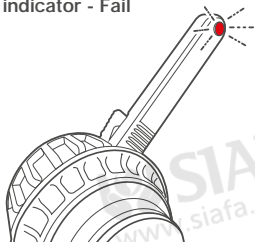

A red light blinking on the LED indicator for a failed check. Wait until the LED indicator flashes purple signalling a retest for the fit check.

## Using the QuantiCheck® app

### 1 Connect to your PC

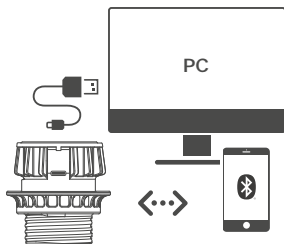

Connect your QuantiCheck® to your PC via the USB port. Alternatively your device can be connected to your smart phone via Bluetooth®.

### 2 Install the QuantiCheck® app

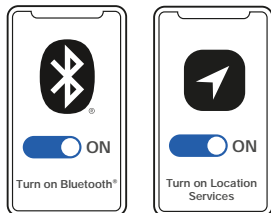

Download and install the QuantiCheck® app on your device.

Available for IOS, Android, PC and can be connected wirelessly via Bluetooth®.

### 3 Turn on your QuantiCheck®

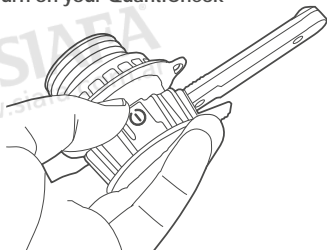

Press and hold power button until green light blinks then release.

#### 4 Connect to your device



\*Wait for the app to discover your QuantiCheck® device  
\*On Windows, device needs firstly to be paired to the PC via Bluetooth®.

#### 5 Choose user

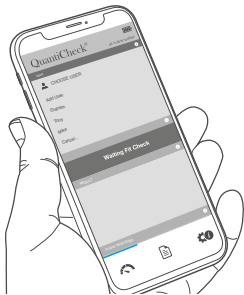

Under users select "Choose User" and select the user or add new user.

#### 6 Don your mask and perform a fit check

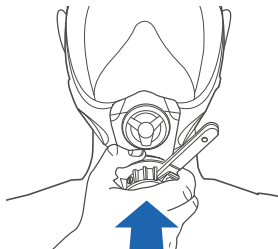

Attach QuantiCheck® to mask and don. To perform a fit check - *"see point 6 on how to perform a check."*

#### 7 Pass or Fail indication

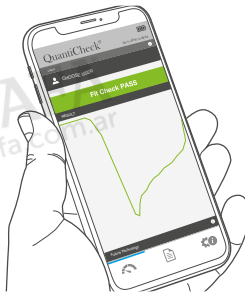

A solid green band will display on the app for a passed check or a solid red band for failed check.

## 8 View your results

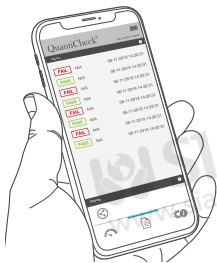

To see the list of results press the 'Reports' icon on the foot of the app.

## 9 Share and download results



To share or download your results locate the relevant icon below the reports and share or download.

## A Passed fit check

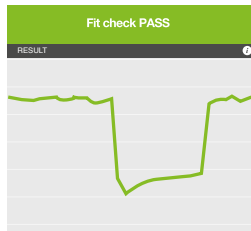

A positive pull fit check trace line shows a single large fluctuation, followed by a gently increasing line before rising again at the end of the fit check upon releasing breath.

## B Damaged or leaking seal

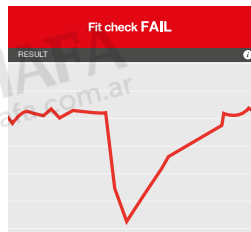

A negative pull fit check trace line shows large fluctuations or drops rapidly when there is a leak or a poorly fitted mask.



# QuantiCheck<sup>®</sup>

## Contact us

OHD LLLP Tel: +1 (205) 980 0180

[www.ohdglobal.com](http://www.ohdglobal.com)

## Technical Support

[techsupport@ohdglobal.com](mailto:techsupport@ohdglobal.com)

Manufactured by Design Reality